

NOTE:  
 1. CABLE IS ATTACHED TO THE RIGHT SIDE OF TOUCH PANEL AS SHOWN.  
 2. TAIL CONNECTOR: PITCH 2.54mm

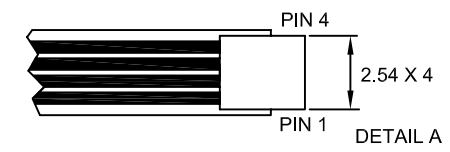
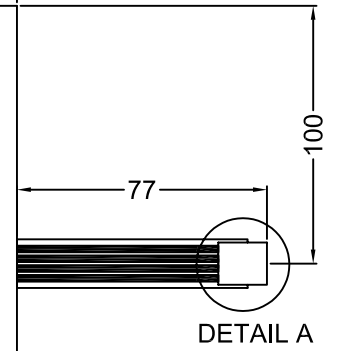

249 ± 0.5 (Overall of Sensor)

232 ± 0.2 (View Area)

228 (Active Area)

325 ± 0.5 (Overall of Sensor)

308 ± 0.2 (View Area)

304 (Active Area)

380.13 [14.97"]

X left

X right

Y down

Y up

P/N	COVERSHEET TYPE	GLASS THICKNESS	FINISHED PART THICKNESS
4WR15021G3	CLEAR	1.8	2.1 ± 0.2
4WR15021N3	ANTI-GLARE		

CONNECTOR PINOUT	
PIN NO	ASSIGNMENT
1	Y down
2	X right
3	Y up
4	X left

宇鴻光電股份有限公司 <b>ATouch Technologies Co., Ltd.</b>		
MODEL NUMBER		4WR15021A3
DRAWN BY	DIMENSION UNIT	ISSUE DATE
KEN JHUANG	mm	12 / 19 / 07
CHECKED BY	SCALE	REV
MELISSA WEI	NOT TO SCALE	E